

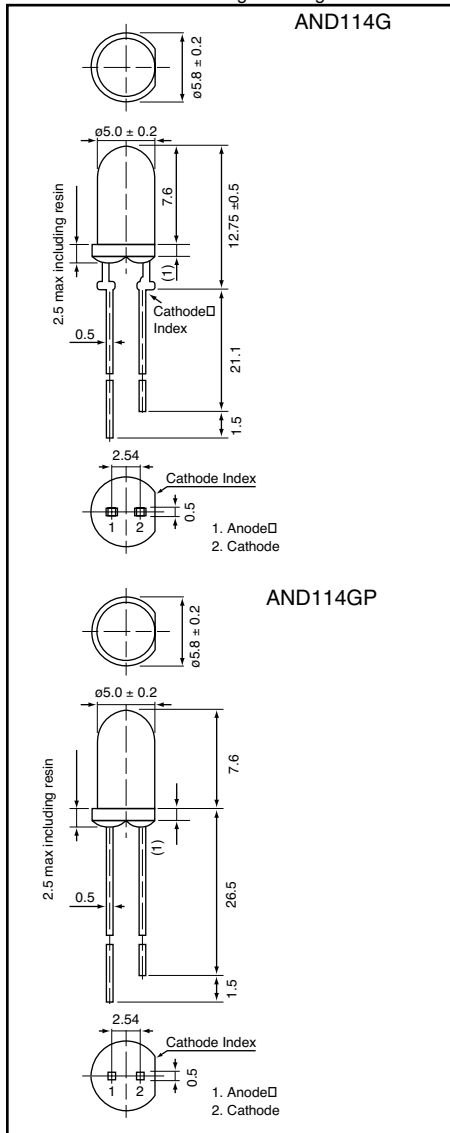

Weight: 0.30 g Unit: mm



Product specifications contained herein may be changed without prior notice. It is therefore advisable to contact Purdy Electronics before proceeding with the design of equipment incorporating this product.

AND114G/GP

Standard LED

T-1 3/4 Package (5 mm)

Features

- Low power requirement
- Flush-mount
- All plastic molded lens
- Color: GaP–Green

• RoHS Compliant

Optical Characteristics (T_a = 25°C)

| Color | | Lens Desc. | Axial Luminous Intensity (mcd) | | Test Condition (I _F –mA) | Viewing Angle 2θ1/2 (deg) |
|-------|-------|------------|--------------------------------|------|-------------------------------------|---------------------------|
| LED | Lens | | Min. | Typ. | | |
| Green | Green | Diffused | 5 | 18 | 10 | 60 |

Absolute Maximum Ratings (T_a = 25°C)

| Characteristics | Symbol | Rating (Yellow) | Unit |
|---------------------------|------------------|-----------------|------|
| Forward Current (DC) | I _F | 25 | mA |
| Reverse Voltage | V _R | 5 | V |
| Power Dissipation | P _D | 105 | mW |
| Operating Temperature | T _{Opr} | -40 to +85 | °C |
| Storage Temperature Range | T _{Stg} | -40 to +85 | °C |

Electro-Optical Characteristics (T_a = 25°C)

| Characteristics | Symbol | Test Condition | Yellow | | | Unit |
|--------------------------|----------------|-----------------------|--------|------|------|------|
| | | | Min. | Typ. | Max. | |
| Forward Voltage | V _F | I _F = 20mA | – | 2.1 | 2.5 | V |
| Reverse Current | I _R | V _R = 5 V | – | – | 10 | μA |
| Peak Emission Wavelength | λ _p | I _F = 15mA | – | 565 | – | nm |
| Spectral Line Half Width | λ | I _F = 15mA | – | 30 | – | nm |

Precaution

Please be careful of the following:

1. Soldering temperature: 260°C max; Soldering time: 5 sec. max; Soldering portion of lead: up to 1.6 mm from the body of the device.
2. The lead can be formed up to 5 mm from the body of the device without forming stress. Soldering should be performed after the lead forming.

